

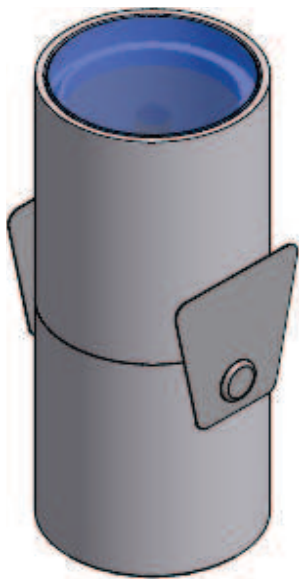







Putter T



-  Anodised
-  IP 67
-  Smart 3 channel drive 350 mA
-  Mono: X-leds 350/700 mA
RGB: 12/24/48 V DC
-  Mono: 1 x 2.5 W
RGB: 1 x 3.25 W
-  Smart 3 channel drive 700 mA
-  D: 37 mm
H: 75 mm

 RJ45 connector
Standard for RGB devices

Option: Putter Floor recessed box
Order Number: 015040000
(See Accessories)

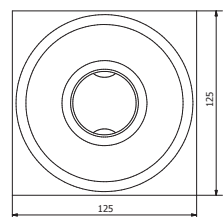
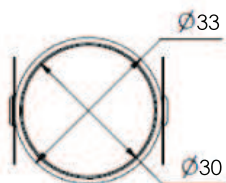
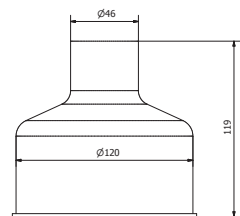
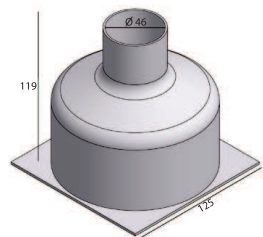
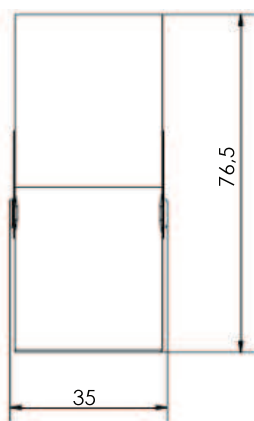

| Colour Beam Temp. Angle | Red | Green | Blue | Amber | 3000 K | 4000 K | 6300 K | RGB |
|-------------------------------|-----------|-----------|-----------|-----------|-----------|-----------|-----------|-----------|
| 10° | 554851212 | 554851312 | 554851512 | 554851612 | 554855212 | 554855312 | 554855812 | - |
| 30° | 554871212 | 554871312 | 554871512 | 554871612 | 554875212 | 554875312 | 554875812 | 554872112 |